

GLASS ACOUSTIC WALL
SYSTEM 7400

Henze
BNP AG,
Lauben



Case study
No. 36





Open room structures

Henze BNP AG is a leading specialist for processing hexagonal boron nitride. The family-run company develops innovative products ranging from technical precision parts to coatings and sprays used for a wide range of industrial applications. The plan was to reflect the huge significance of development and project work at Henze in the new office building. Initially, the design was for completely open room structures which would facilitate the communication between employees and allow them to work more efficiently on projects in work groups. Practice soon revealed that the open-plan office designed for ten to twelve people improved the dialogue between employees. However, discussion and phone calls increased noise intensity – despite an acoustic ceiling and carpets.

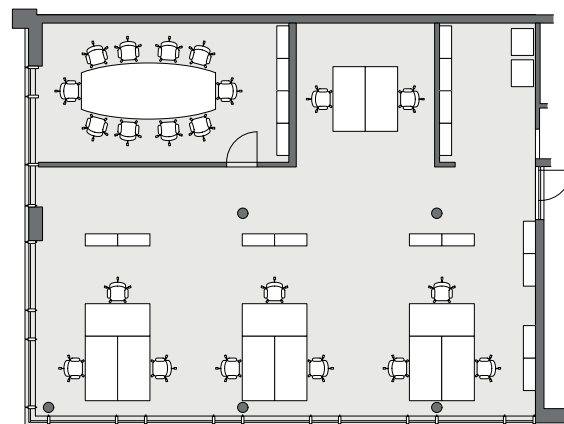

Open offices - the layout prior to the conversion

Client:
Henze BNP AG, Lauben
Architecture:
Dobler GmbH & Co. KG
Planungsbüro
Room acoustics:
Fuchs Raumingenieure GmbH

Product:
Glass acoustic wall system 7400

Transparent solution

With the help of the top-quality glass acoustic wall System 7400, it was possible to maintain the transparent and communicative office design whilst creating an atmosphere compatible to concentrated working. Planning focussed on optimising the acoustics of the room. The open offices were partitioned using T baffle boards arranged in accordance with the building's structure. The columns in the room provided the junction point for the T baffle boards. Visually the room remains one courtesy of the horizontal, half-height sound absorbers. At the same time the workplaces are shielded acoustically from one another and offer more individuality. The micro-perforated absorber elements are designed with human voices in mind. Thanks to their special layered construction, they cover a wide frequency range from 100 to 5000 Hz.



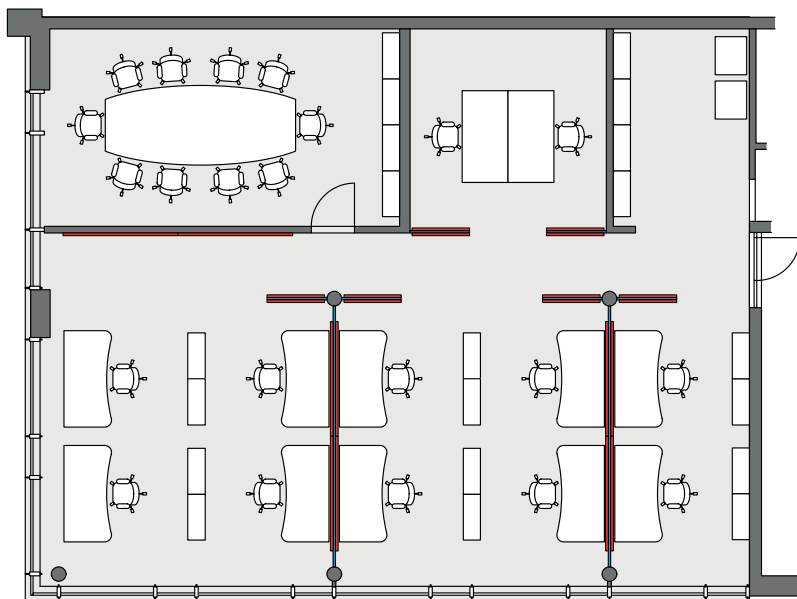

Offices zoned using T baffle boards from the Strähle glass acoustic wall System 7400



Audibly good working environment

After the glass acoustic partition walls had been erected, acoustics engineering consultants Fuchs - Raumingenieure GmbH carried out tests to measure reverberation times and sound level differences. The recorded values almost equalled the acoustic quality of a closed, simple system partition wall fitted with 10-mm toughened glass including an all-glass door.

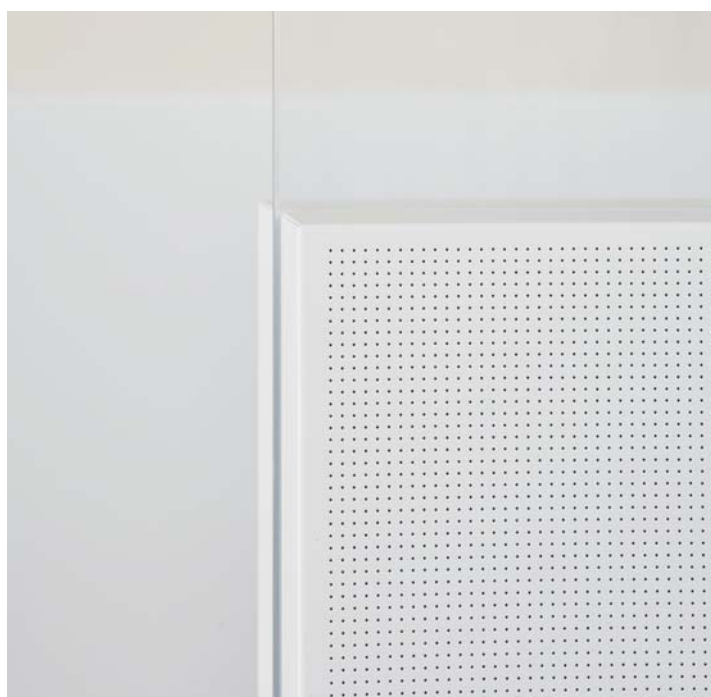
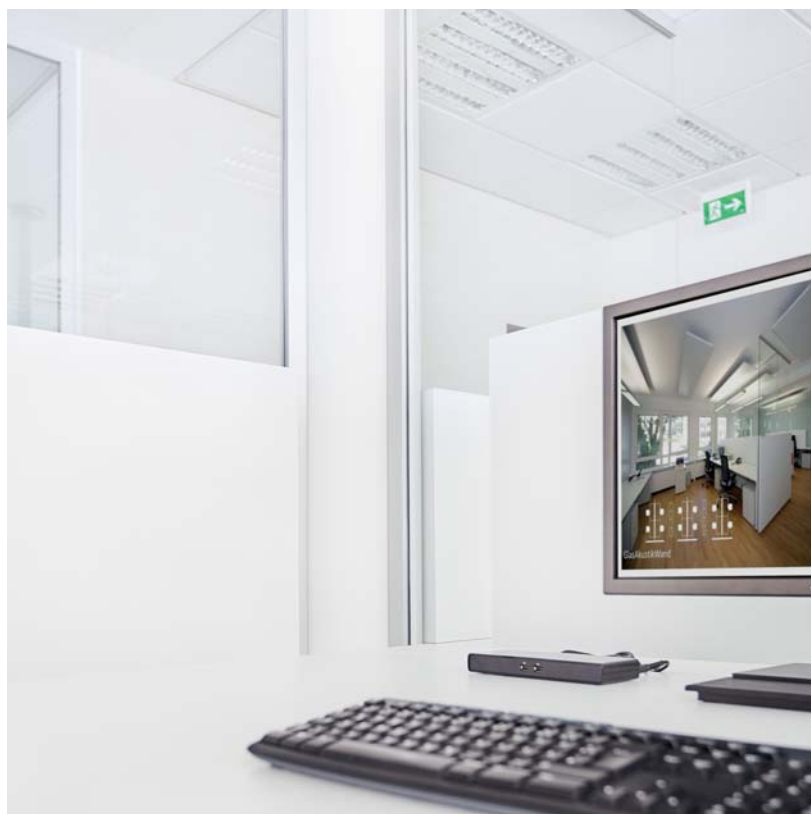



Light
transparency
Glazing

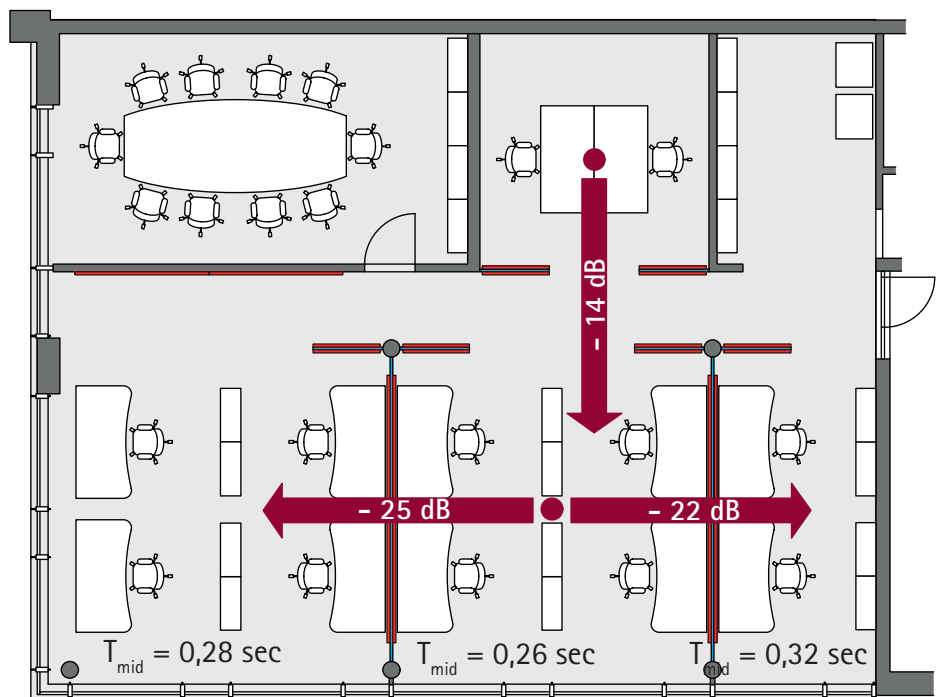

„The installation of Strähle glass
 acoustic walls brought a new quality
 to the workplace in our offices.
 We are so satisfied that we have
 already issued the order for
 upgrading the next floor up,
 Christoph Henze,
 Chairman of Henze BNP AG

Strähle Raum-Systeme GmbH
www.straehle.de
info@straehle.de

GERMANY
Gewerbestraße 6
71332 Waiblingen
T +49 7151 1714-0
F +49 7151 1714-320

Wurzelweg 5
14822 Borkheide
T +49 33845 66-0
F +49 33845 66-199

AUSTRIA
Industriestraße 9
2353 Guntramsdorf
T +43 2236 23232-0
F +43 2236 23232-13

SCHWITZERLAND
Dellenbodenweg 1
4452 Itingen
T +41 61 463 1332
F +41 61 463 1333